

MILEAGE OF ROAD IN THE CITY OF NORTHFIELD
 STATE ROADS = 1.8 MILES
 COUNTY ROADS = 8 MILES
 CITY ROADS = 37.5 MILES

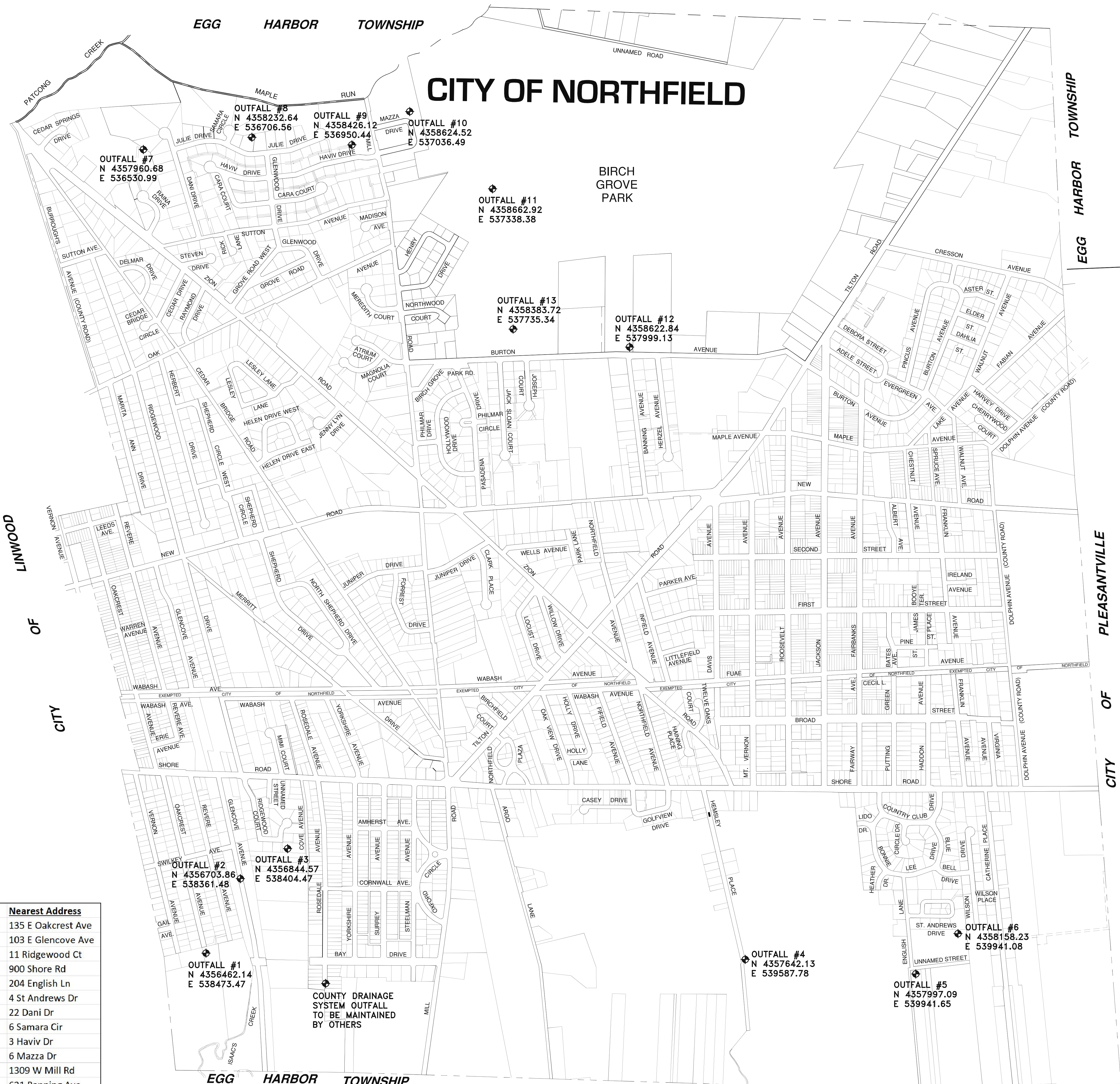

	Latitude	Longitude	Northing	Easting	Nearest Address
1	39.35675323	-74.55344061	4356462.14	538473.47	135 E Oakcrest Ave
2	39.35893599	-74.55472663	4356703.86	538361.48	103 E Glencove Ave
3	39.36020178	-74.55421982	4356844.57	538404.47	11 Ridgewood Ct
4	39.36733472	-74.54043804	4357642.13	539587.78	900 Shore Rd
5	39.37051730	-74.53630888	4357997.09	539941.65	204 English Ln
6	39.37196893	-74.53630583	4359941.08	4 St Andrews Dr	
7	39.37034013	-74.57590490	4357960.68	536530.99	22 Dani Dr
8	39.37278282	-74.57385187	4358232.64	536706.56	6 Samara Cir
9	39.37451616	-74.57101049	4358426.12	536950.44	3 Haviv Dr
10	39.37630000	-74.57000000	4358624.52	537036.49	6 Mazza Dr
11	39.37663279	-74.56649349	4358662.92	537338.38	1309 W Mill Rd
12	39.37624337	-74.55882399	4358622.84	537999.13	621 Banning Ave
13	39.37410000	-74.56190000	4358383.72	537735.34	2 Jack Sloan Ct

COUNTY DRAINAGE SYSTEM OUTFALL TO BE MAINTAINED BY OTHERS

REV #	DATE	BY	REVISION DESCRIPTION

DATE: _____
 SCALE: NTS
 BY: BG
 CHECKED: RNN
 SHEET NO. **1**
 1 OF 1

FILE# NF13-46

OUTFALL LOCATION MAP FOR:
CITY OF NORTHFIELD
 ATLANTIC COUNTY, NEW JERSEY

RAMI N. NASSAR
 PROFESSIONAL ENGINEER

 NEW JERSEY LIC. NO. 34902
 DATE: 02/12/20

Schaeffer Nassar
 CONSULTING ENGINEERS, LLC
 Surveyors • Environmentalists • Planners
 1425 Canton Boulevard • New Jersey
 Telephone: (609) 625-7400 • Fax: (609) 909-0253
 Certificate of Authorization #24GA28103800